

Housing Authority of the
County of Lebanon

Accessibility Improvements – Webster Manor

Addendum 1 – August 8, 2018

Specifications for the above referenced solicitation has been changed in accordance with the attached addendum 1 and revised drawing SK-1 from Fedetz and Martin Associates, PC dated August 7, 2018. All other terms and conditions of the original solicitation remain unchanged.

Proposed forms of contract documents, including plans and specifications may be obtained in electronic PDF format on the Authority website – <http://www.lebanoncountyhousing.com>.

Housing Authority of the County of Lebanon

Bryan D. Hoffman
Executive Director



FEDETZ & MARTIN ASSOCIATES, P.C
ARCHITECTURE & PLANNING

Kiprian A. Fedetz, A.I.A.
1837 Roth Ave.
Allentown, PA 18104
(610) 432-9924
(610) 432-4571 Fax

ADDENDUM #1

August 7, 2018

**LEBANON COUNTY HOUSING AUTHORITY
ALTERATIONS FOR ACCESSIBILITY
WEBSTER MANOR – 974-976 Steckbeck Street**

This addendum shall be made part of the Contract Documents.

CLARIFICATIONS:

1. The Housing Authority will apply for and pay for building permits. The successful contractors will be responsible for complying with Township requirements for licenses and insurance. Each contractor will pick up their appropriate permit.

PROJECT MANUAL:

2. Section 01012 Architect's Special Conditions – Part 5, change Liquidated Damages to \$100.
3. Section 07115 Sheet Waterproofing – Accepted equal products:
 - a. PT-60 Preformed Sheet Membrane by Poly-Tuff.
 - b. Mel-Rol by W.R. Meadows.
4. Section 08710 Finished Hardware – All electronic door locksets shall be supplied by the Housing Authority and installed by the General Contractor.
5. Section 08710 Finished Hardware – Part 3.3 Schedule; Change all Schlage hardware to F Series, Plymouth Trim, Latitude lever, in satin chrome. Functions remain as specified.
Set # 3 – “lock-in bolts” shall be flush bolts.

DRAWINGS:

C-1.1

6. See attached SK-1 dated 8-7-2018, for revision to the location of the Electric Transformer.

C-1.3

7. All underground electrical work is by the Electrical Contractor including trenching, conduit, cables, backfilling and surface restoration.

S-2.0

8. The cutting and new recessed slab for the first floor showers is by the General Contractor.

A-2.6

9. Finish Schedule – Change Dining Room flooring to LVT. Stairs shall get vinyl treads and risers. The Stair Landings shall get LVT.
10. Finishes – Change Sheet Vinyl to Mannington “Coral Bay” #130100 with scratch resist HP and permanent bond.

END OF ADDENDUM

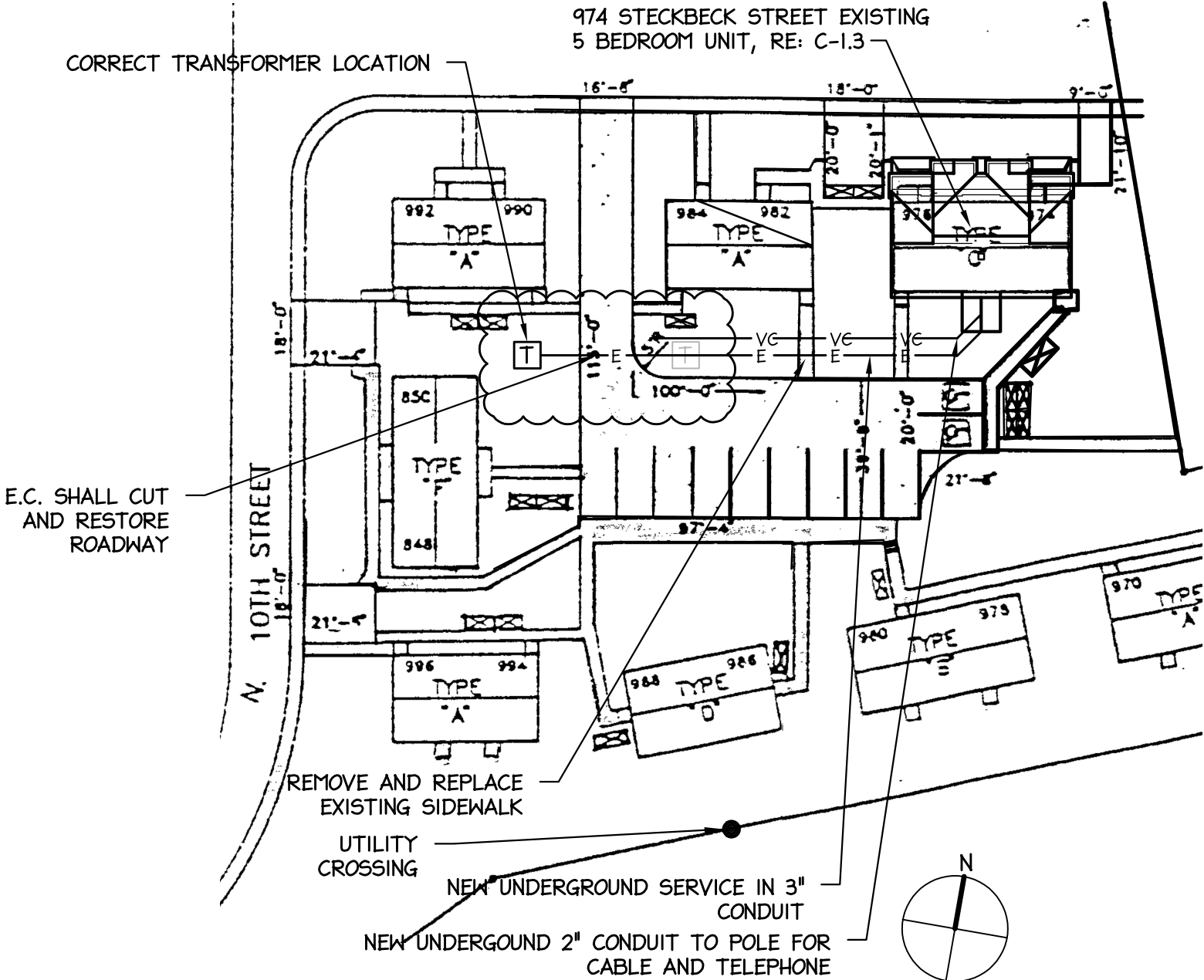

NOTE:
 ALL TRENCHING CONDUIT AND RESTORATIONS
 FOR UNDERGROUND ELECTRICAL WORK BY E.C.

1 SK-V 974-976 STECKBECK SITE PLAN

NOT TO SCALE

LEBANON COUNTY HOUSING AUTHORITY WEBSTER MANOR - ACCESSIBILITY WORK 974-976 STECKBECK STREET LEBANON, PA 17042		DATE:
		<small>DRAWINGS & DESIGNS DEPICTED ARE COPYRIGHTED © 2016</small> DRAWN BY: BAH CHECKED BY: KAF DRAWING NAME: <small>DISG: H/ DWG: /LEBCHA/ NAME:</small> PROJECT CODE: <small>17LEB000</small>
 FELETZ & MARTIN ASSOCIATES, P.C. ARCHITECTURE & PLANNING 1837 ROTH AVENUE ALLENTOWN, PA 18104 610-432-9924 WWW.FMAARCH.COM		DESCRIPTION: DRAWING NO: SK-1